



The Olliver Buildings are situated at Aske near Richmond in North Yorkshire. Built in 1850 Olliver was one of the first Model Farms in England and in late 2005, work began to convert these splendid old buildings into modern offices. Building2 offers 1,500 sqft of modern prestigious offices, toilets and kitchen.

TO LET

ONE OFFICE
650 SQ FT
REFURBISHED VICTORIAN FARM BUILDINGS
BEAUTIFUL RURAL SETTING
MODERN SPECIFICATION
ECO-FRIENDLY BIOMASS HEATING
AMPLE PARKING





Facilities

The development is finished to an extremely high standard and includes:

- Modern refurbished offices
- Kitchenette area
- Male and Female/Disabled toilet facilities
- CAT2 Lighting
- CAT5 Voice/Data (in some)
- Carpeted throughout
- Intruder Alarm system & Fire Alarm system
- Biomass Heating Technology
- Broadband available
- Ample Parking

Offices Currently Available

Office Ref	Size	Available
B2-Office1	650 sq ft	NOW
B2-Office2	260 sq ft	Let

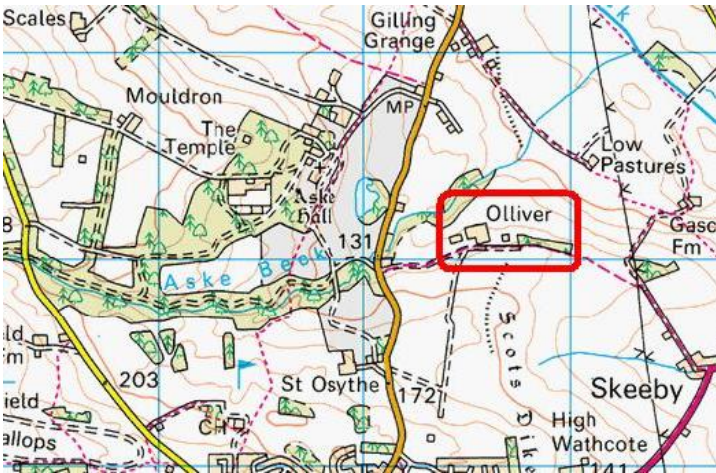
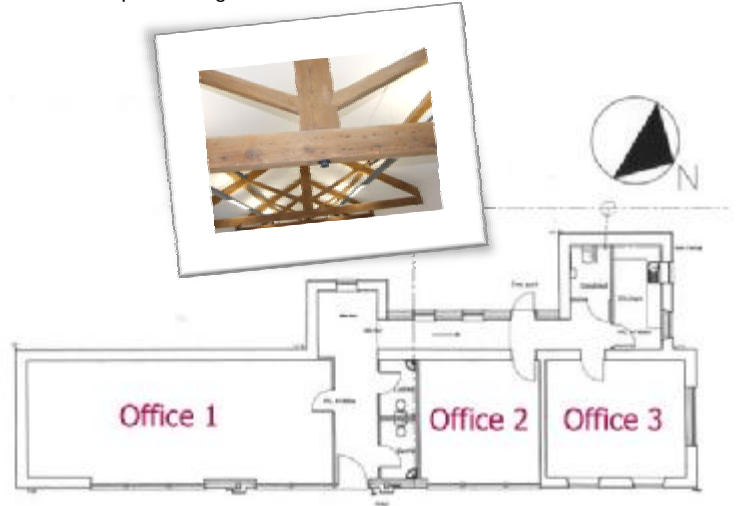

Location

Olliver is located on the edge of the Yorkshire Dales National Park just outside the Georgian market town of Richmond on the B6274.

- § Just minutes from A66 and A1 (m) North/South at the Scotch Corner
- § Train station at Darlington
- § Durham Tees Valley Airport, offering domestic and international flights less than 25 miles away
- § Leeds Bradford Airport, offering domestic and international flights approx 55 miles away
- § 1 hour from major cities Newcastle, York and Leeds
- § 2 hours by train to London

Terms

The offices are available to let individually or in multiples on either a Tenancy Agreement or full repairing and insuring lease dependant on term. Further details are available on request.

Viewing

Strictly by appointment. Please contact Purple Leaf on 01748 821888 or email olliver@purple-leaf.co.uk

Purple Leaf, Aske Stable, Aske, Richmond, North Yorkshire. DL10 5HG

